

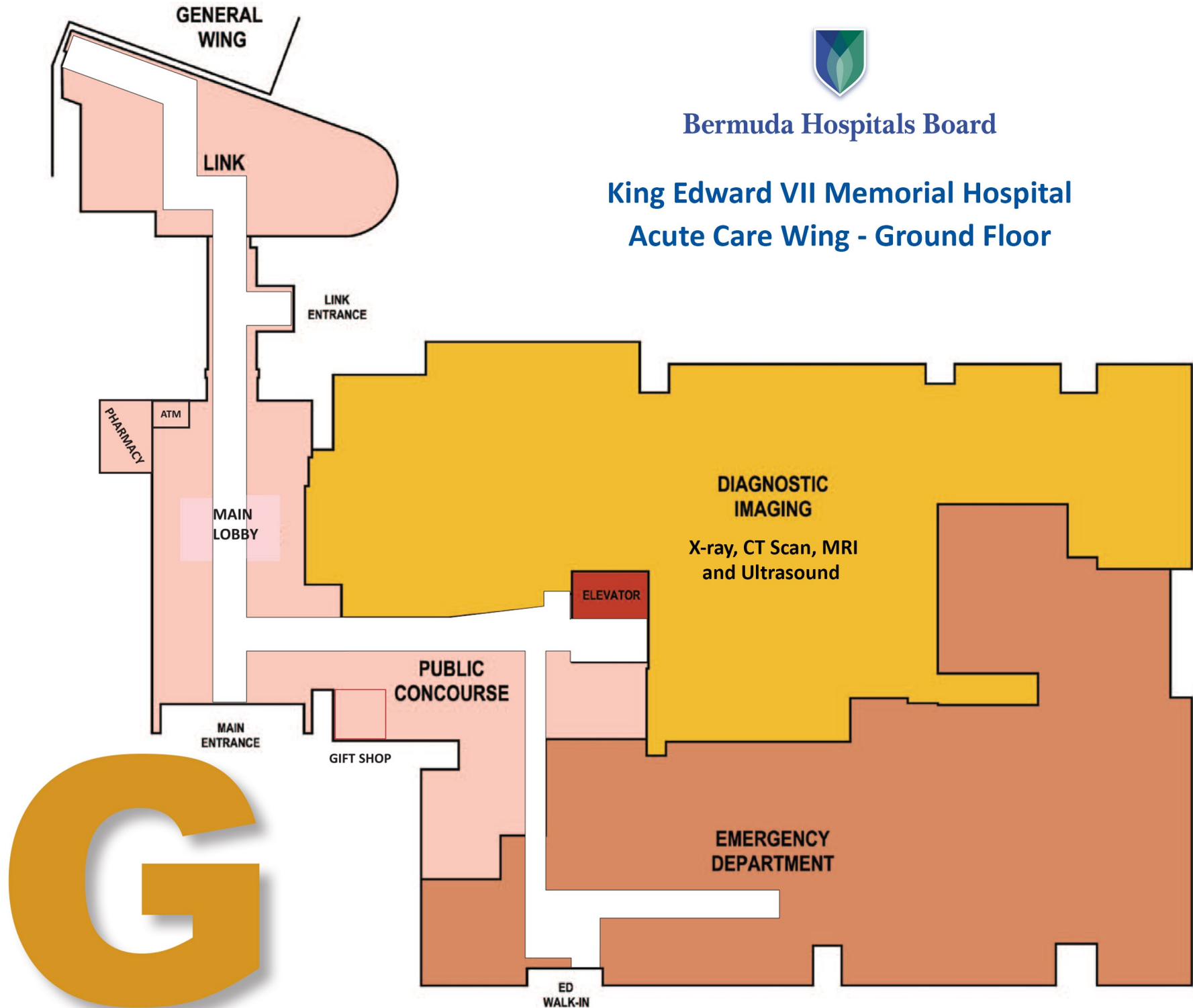

Bermuda Hospitals Board

King Edward VII Memorial Hospital
Acute Care Wing - Ground Floor





Bermuda Hospitals Board
King Edward VII Memorial Hospital
Acute Care Wing - 1st Floor

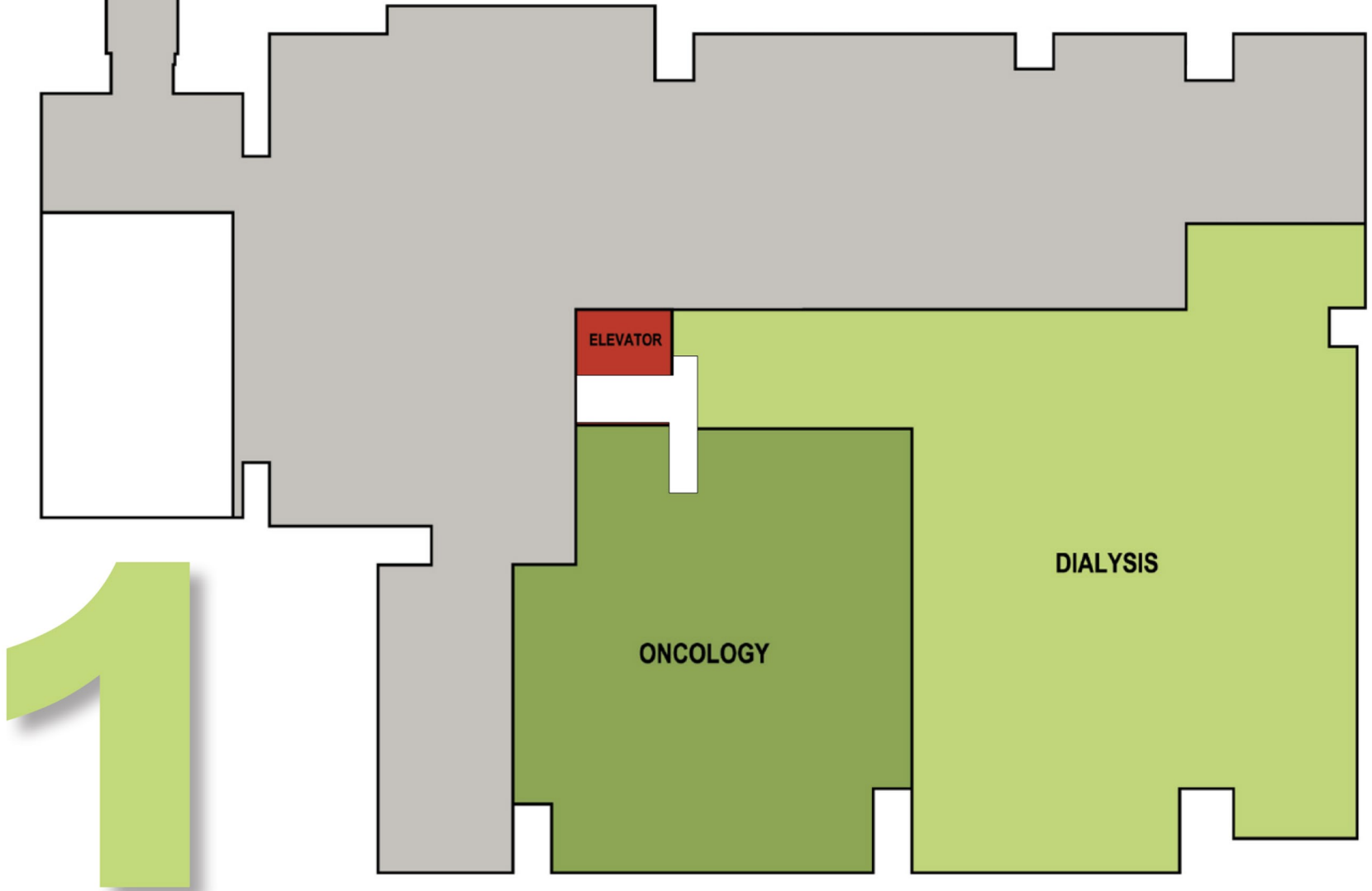

1



Bermuda Hospitals Board

**King Edward VII Memorial Hospital
Acute Care Wing - 2nd Floor**

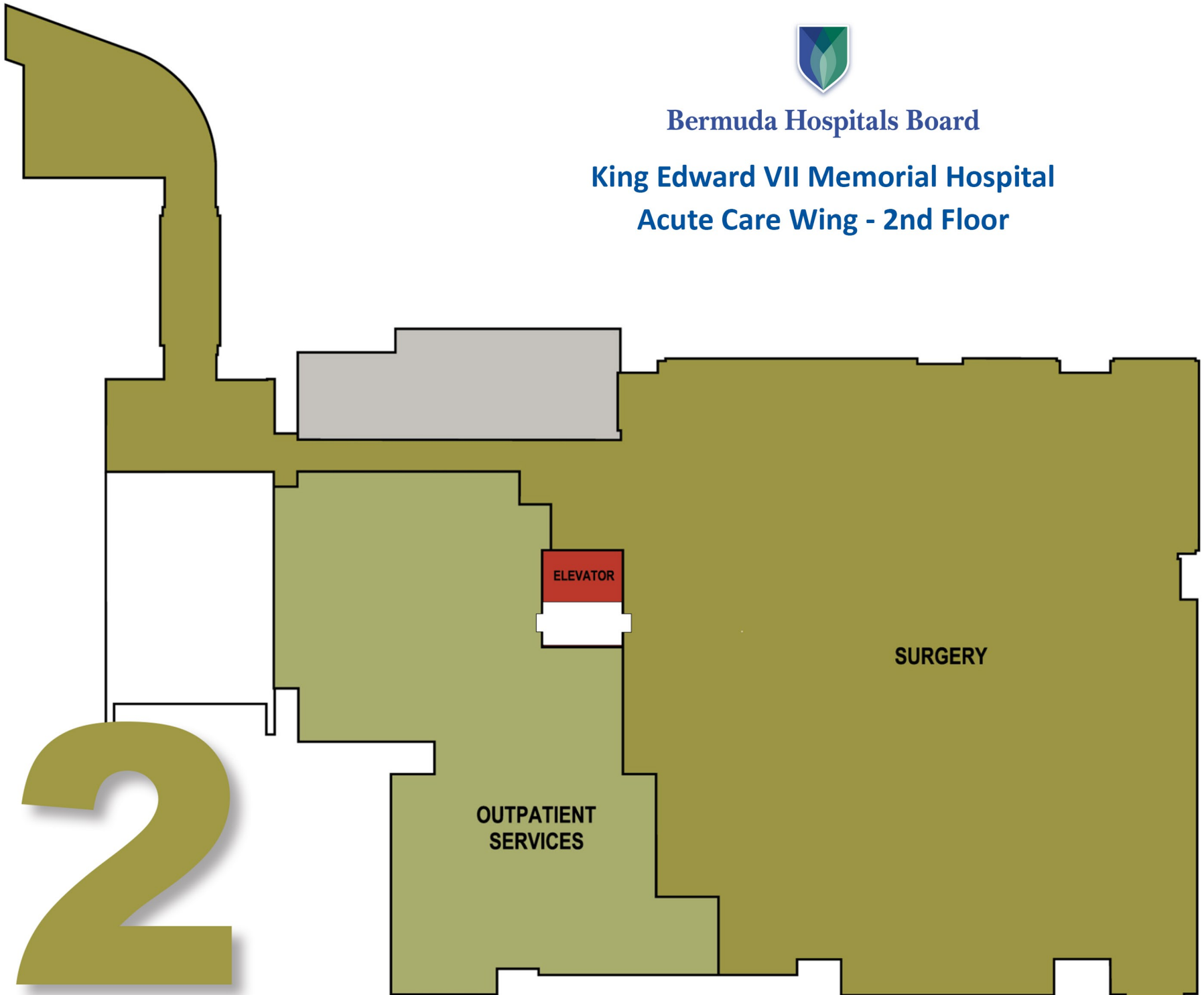

ELEVATOR

SURGERY

OUTPATIENT
SERVICES

2



Bermuda Hospitals Board

King Edward VII Memorial Hospital
Acute Care Wing - 3rd, 4th and 5th Floors

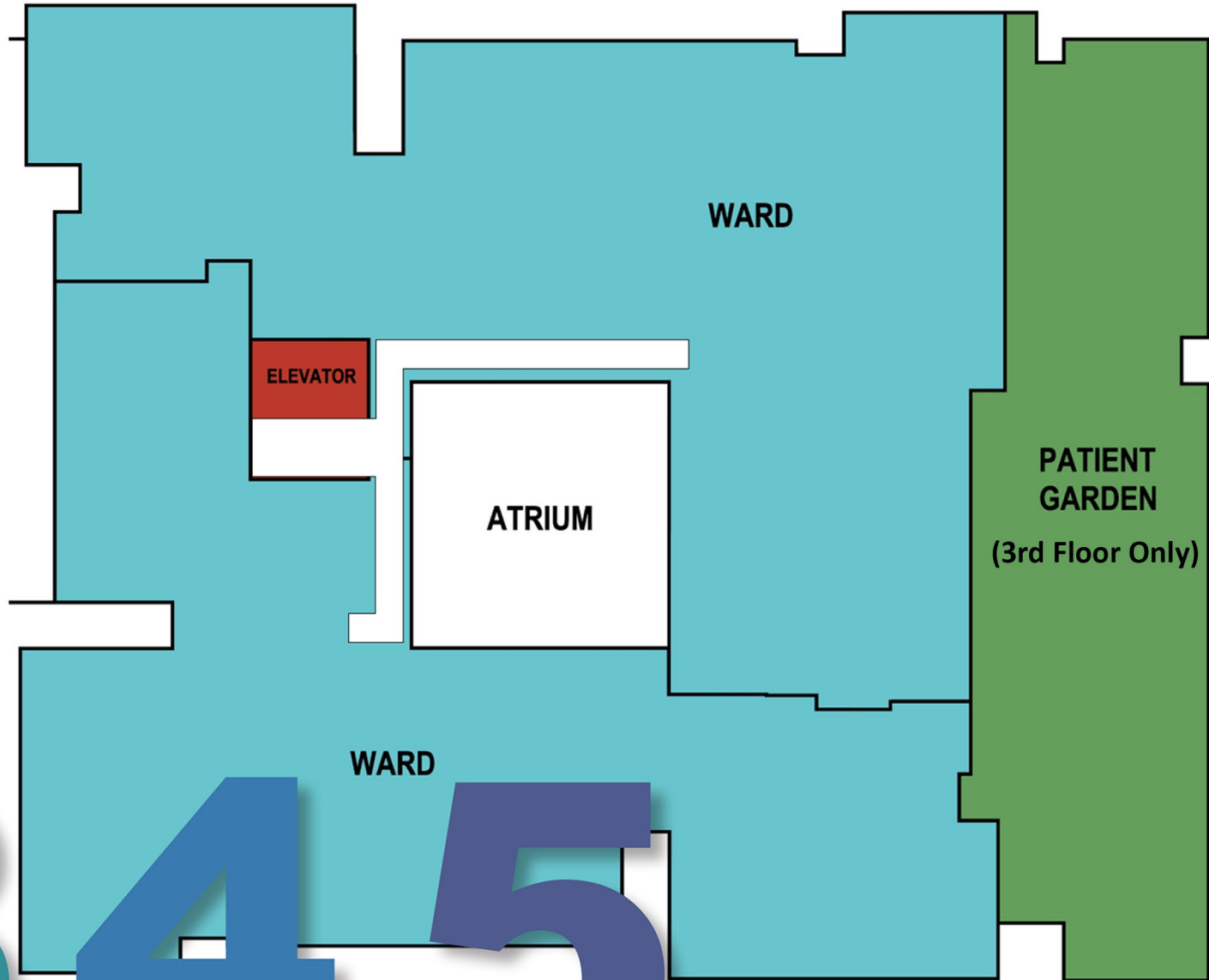

3, 4, 5